

12 Way Terminal Blocks

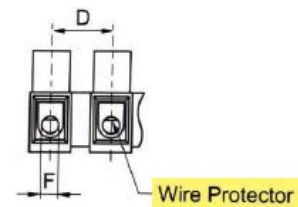
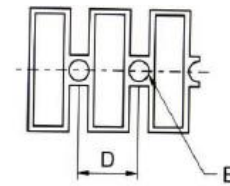
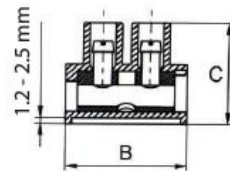
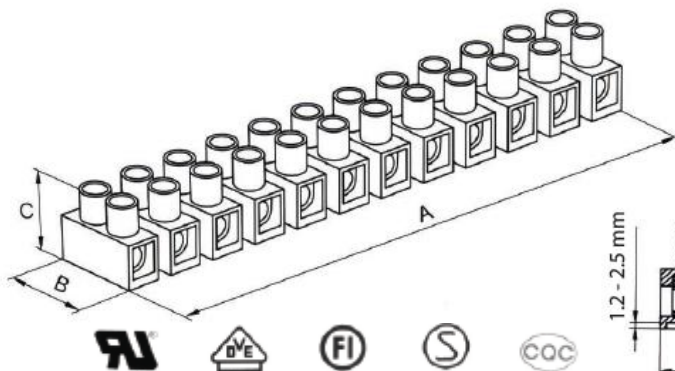
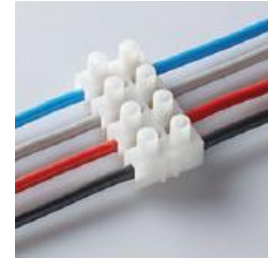
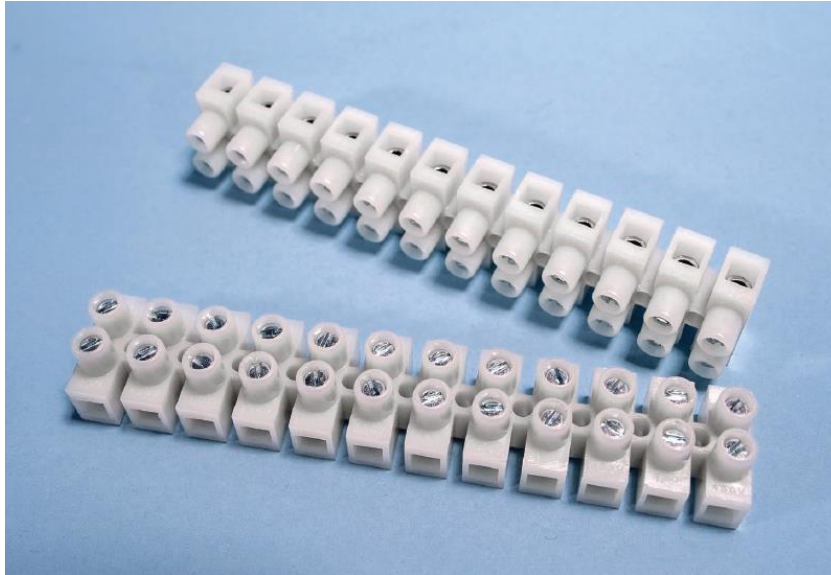

PART#	CABLE SIZE	ELECTRICAL RATING	RAISED BASE (mm)	SCREW	WIRE PROTECT	DIMENSIONS					
						A	B	C	D	E	F
NPA31611	0.75 - 1.5 mm	17.5 A, 450 V 20 A, 300 V	1.2	M2.6x5	With	96.2	17	14.5	8	2.9	2.8±0.1
NPA31613	1 - 2.5 mm	24 A, 450 V 30 A, 300 V	1.2	M3.0x6	With	117.5	20.2	17	10	3.6	3.4±0.1
NPA31615	2.5 - 6 mm	41 A, 500 V to 35 A, 300 V	1.2	M3.5x7	With	140.7	23.8	19	12	3.9	4.2±0.1
NPA31617	4 - 10 mm	57 A, 500 V to 50 A, 300 V	2.5	M3.0x6	With	158	25.6	25.2	13.5	4.4	5.0±0.1

FEATURES:

- Includes wire protection.
- Recessed screws and tubular contacts provide added safety and help prevent short circuits.
- 12 poles, can be cut into desired poles.
- For use in electrical appliances, lighting and building wiring, especially in OEM & Industry applications.

QUICK SPECS:

- Housing: Polyamide 66, flame-retardant to UL 94V-2.
- Working Temp: -25°C to 105°C.
- Terminal Body: Brass alloy, nickel-plated.
- Wire Protector: Stainless spring steel.
- Screw: Steel, zinc-plated.